



UMMANNAK
İHTİYACINIZA ÖZEL ÇÖZÜMLER İÇİN

SPECIFICATIONS

UNIT

Mixer Specifications	Plant Capacity	m³/h	120
	Mixer Specifications	m³/h	3
	Dry Filling Volume	Liter	4000
	Compacted Concrete	Liter	3000
	Motor Power	kW	2x55
Weighing Bin Capacity	Cement Weighing Capacity	kg	1800
	Water Weighing Capacity	kg	1000
	Additive Weighing Capacity	kg	20
	Aggregate Compartments	Piece	4-5
Aggregate Bin	Bin Capacity	m³	20-30
	Aggregate Weighing Capacity	kg	6000
	Width	mm	1000
Transfer Belts	Length	mm	30000
	Motor Power	kW	30
	Diameter	Ø	273
Cement Screw Conveyor	Length	mm	11500
	Motor Power	kW	15
	Pressure	bar	6-8
Air Compressor	Air Tank	Liter	600
	Store House	L/dk	1657
	Motor Power	kW	7,5
	Weight	ton	55
Total Power	kW	215	
Transport Type	4 Container		



GORDION

STATIONARY 120 M³ DRY-WET CONCRETE BATCHING PLANT

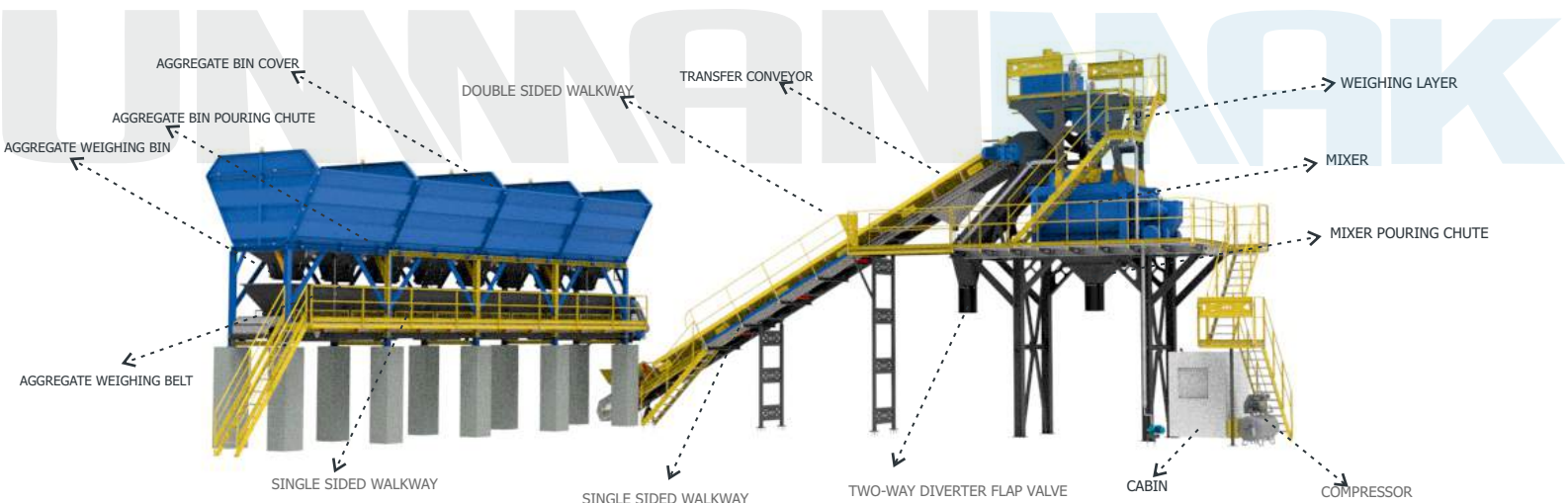

OUR MIXER QUALITY

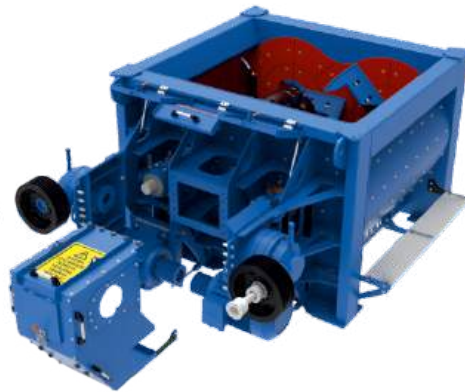

*The front surface reducer part of the mixer can be opened easily. In this case, maintenance operations can be carried out more easily.



*Planetary reducer is used. *2*55 kW motor is used.



*Mixer SKF brand automatic and manual lubrication is available.



*There is an emergency stop button that may occur regarding the mixer.



*3 pieces telemechanical switches are available.



*Hydraulic unit is available.

CONTACT US!

UMMAN A.S.
Address: İvedik O.S.B 1341.Cad.
No:71 Yenimahalle / ANKARA
Phone : +90 312 394 19 90
Fax: +90 312 394 19 94
E-mail: info@umman.com.tr
Web: www.umman.com.tr



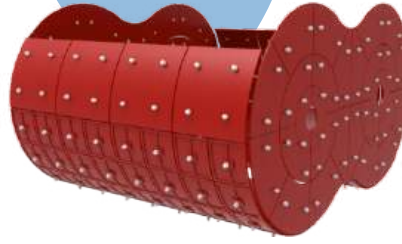
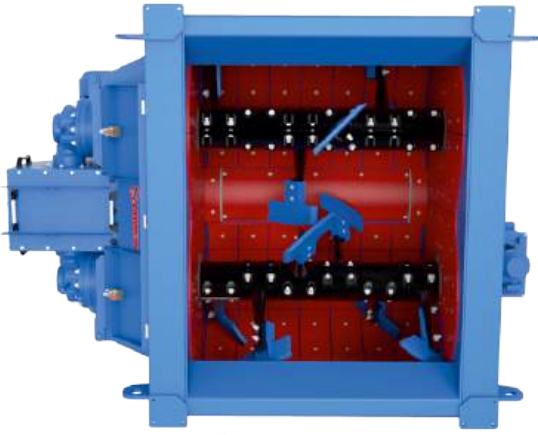

**Mixer wear-resistant parts are made of Ni-hard material.

*Mixer, mixer and scraper arm group is made of Ni-hard material.

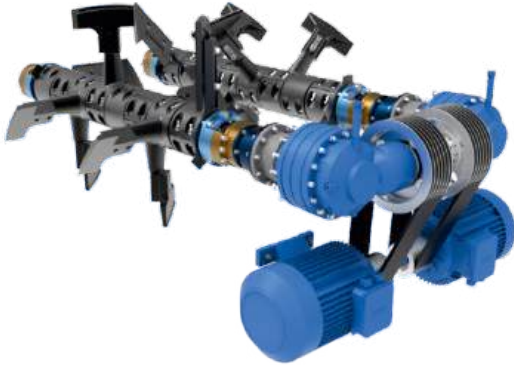

*Mixer bearing part is available.



*Mixer lower pouring chute is available.



*Mixer upper cover part is available.

OUR TRANSFER CONVEYOR QUALITY



*Drum coating is available.



*KR type reducer is used.



*Guide roller part is available.



*SNL bearing type is used.



*Rope switch is used.

TWO-WAY DIVERTER FLAP VALVE



*Pneumatic controlled piston available.



*Vibromotor is available.

*Water inlet available

CONTACT US!

UMMAN A.S.
Address: İvedik O.S.B 1341.Cad.
No:71 Yenimahalle / ANKARA
Phone : +90 312 394 19 90
Fax: +90 312 394 19 94
E-mail: info@umman.com.tr
Web: www.umman.com.tr



OUR WEIGHING LAYER QUALITY



*Cement weighing bin is available.



*Water weighing bin is available.



Aggregate weighing bunker is available



*Vibromotor is available.

*The valves with flap and actuators are available



*The valves with flap and actuators are available



*1" ball valve with actuator is available.

OUR AGGREGATE BIN QUALITY

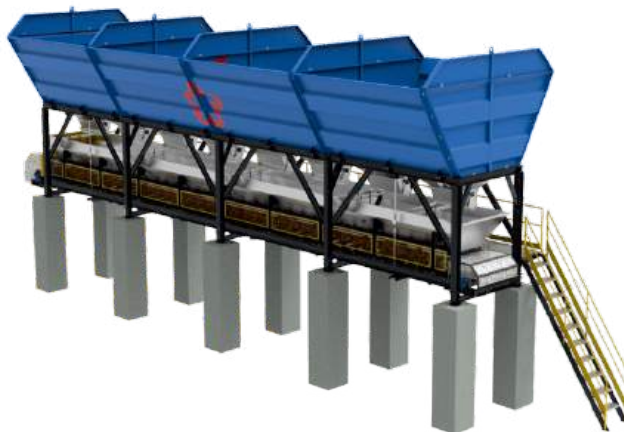

*Aggregate bin covers are available.



*Aggregate weighing bin is available



*Aggregate pouring chute is available.



*Vibromotor is available.



*Vibromotor is available.



*Pneumatic controlled piston available.

CONTACT US!

UMMAN A.S.
Address: İvedik O.S.B 1341.Cad
No:71 Yenimahalle / ANKARA
Phone : +90 312 394 19 90
Fax: +90 312 394 19 94
E-mail: info@umman.com.tr
Web: www.umman.com.tr





*Aggregate weighing belt is available



*Drum coating is available.*KR type reducer is used.*Rope switch is used.



*Guide roller part is available. *SNL bearing type is used.



MIXER POURING CHUTE



*Since the mixer pouring chute is bolted, it provides ease of maintenance.



*0.75 kW single stage additive pump is available.



*3" valve with butterfly actuator is available.



*Valve is available.



*Dalgakiran compressor is available.

OUR PLANT EQUIPMENT

CABIN AND AUTOMATION



*Dimension(mm):2000x2000x3000
*PVC System (Insulating Glass) Insulation, Walls polystyrene foam, ceiling glass wool



*Siemens/ABB Switching material
*Omron/PLC
*Laptop
*Manual Control (Mimic)
*Air conditioner: Available (9000 btu)



*Fully automatic operating system
*Weighing indicator very useful and easy interface
*Software (Cabiness)
*Preparation and printing of requested reports

SETTLEMENT PLAN

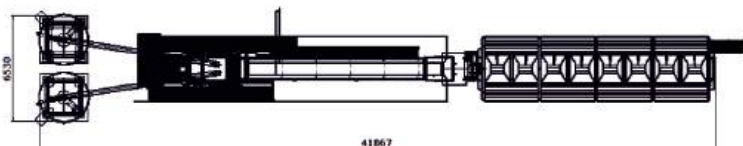
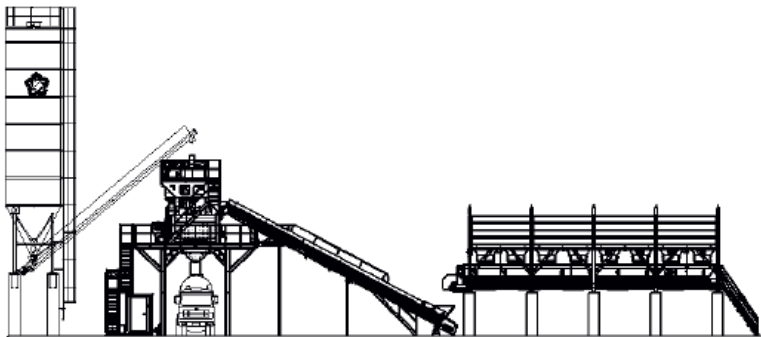

TRANSPORT PLAN

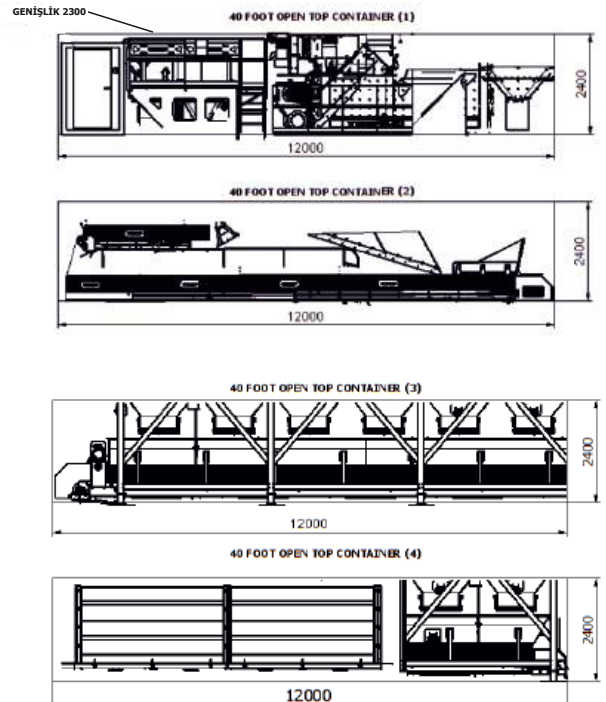

CONTACT US!

UMMAN A.S.
Address: İvedik O.S.B 1341.Cad.
No:71 Yenimahalle / ANKARA
Phone : +90 312 394 19 90
Fax: +90 312 394 19 94
E-mail: info@umman.com.tr
Web: www.umman.com.tr



