



**UMMANNAK**  
İHTİYACINIZA ÖZEL ÇÖZÜMLER İÇİN

**SPECIFICATIONS**

	SPECIFICATIONS	UNIT	VALUE
<b>Mixer Specifications</b>	<b>Plant Capacity</b>	m³/h	60
	Mixer Specifications	m³/h	1
	Dry Filling Volume	Liter	1500
	Compacted Concrete	Liter	1000
	Motor Power	kW	2x22
<b>Weighing Bin Capacity</b>	Cement Weighing Capacity	kg	500
	Water Weighing Capacity	kg	250
	Additive Weighing Capacity	kg	20
	Aggregate Compartments	Piece	4-5
<b>Aggregate Bin</b>	Bin Capacity	m³	20-30
	Aggregate Weighing Capacity	kg	6000
	Width	mm	800
<b>Transfer Belts</b>	Length	mm	18000
	Motor Power	kW	30
	Diameter	Ø	219
<b>Cement Screw Conveyor</b>	Length	mm	11500
	Motor Power	kW	11
	Pressure	bar	6-8
<b>Air Compressor</b>	Air Tank	Liter	500
	Store House	L/dk	1013
	Motor Power	kW	5,5
	<b>Weight</b>	ton	45
<b>Total Power</b>	kW	125	
<b>Transport Type</b>	4 Container		



# AGONYA

## STATIONARY 60 M³ DRY-WET CONCRETE BATCHING PLANT



### OUR MIXER QUALITY

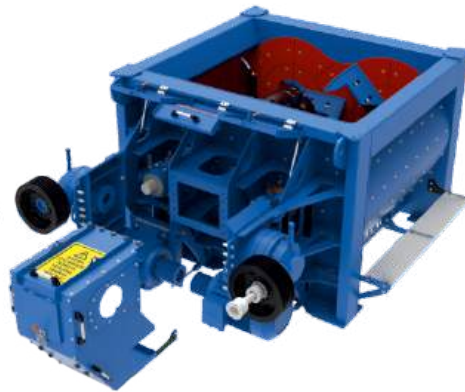

\*The front surface reducer part of the mixer can be opened easily. In this case, maintenance operations can be carried out more easily.



\*Planetary reducer is used. \*2\*55 kW motor is used.



\*Mixer SKF brand automatic and manual lubrication is available.



\*There is an emergency stop button that may occur regarding the mixer.



\*3 pieces telemechanical switches are available.



\*Hydraulic unit is available.

### CONTACT US!

UMMAN A.S.  
Address: İvedik O.S.B 1341.Cad.  
No:71 Yenimahalle / ANKARA  
Phone : +90 312 394 19 90  
Fax: +90 312 394 19 94  
E-mail: info@umman.com.tr  
Web: www.umman.com.tr



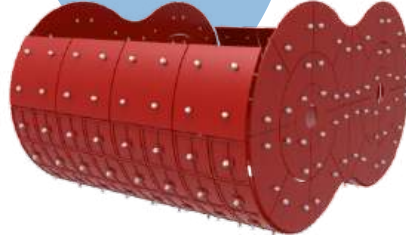
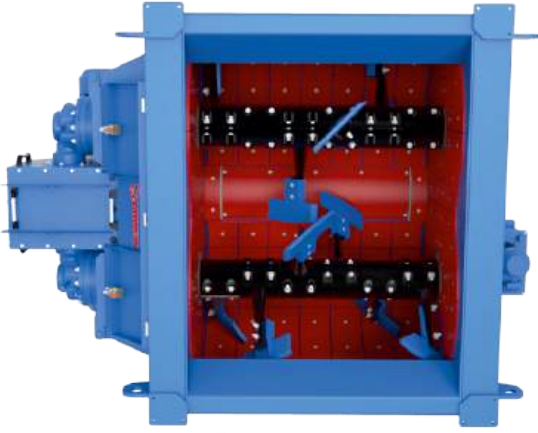

\*\*Mixer wear-resistant parts are made of Ni-hard material.

\*Mixer, mixer and scraper arm group is made of Ni-hard material.



\*Mixer bearing part is available.



\*Mixer lower pouring chute is available.



\*Mixer upper cover part is available.

## OUR TRANSFER CONVEYOR QUALITY



\*Drum coating is available.



\*KR type reducer is used.



\*Guide roller part is available.



\*SNL bearing type is used.



\*Rope switch is used.

## TWO-WAY DIVERTER FLAP VALVE



\*Pneumatic controlled piston available.



\*Vibromotor is available.

\*Water inlet available

**CONTACT US!**

UMMAN A.S.  
Address: İvedik O.S.B 1341.Cad.  
No:71 Yenimahalle / ANKARA  
Phone : +90 312 394 19 90  
Fax: +90 312 394 19 94  
E-mail: info@umman.com.tr  
Web: www.umman.com.tr



## OUR WEIGHING LAYER QUALITY



\*Cement weighing bin is available.



\*Water weighing bin is available.



\*Aggregate weighing bunker is available\*



\*Vibromotor is available.

\*The valves with flap and actuators are available



\*The valves with flap and actuators are available



\*1" ball valve with actuator is available.

## OUR AGGREGATE BIN QUALITY

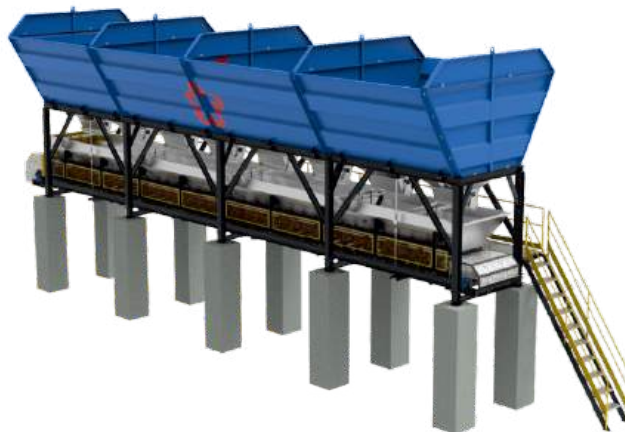

\*Aggregate bin covers are available.



\*Aggregate weighing bin is available



\*Aggregate pouring chute is available.



\*Vibromotor is available.



\*Vibromotor is available.



\*Pneumatic controlled piston available.

**CONTACT US!**

UMMAN A.S.  
Address: İvedik O.S.B 1341.Cad.  
No:71 Yenimahalle / ANKARA

Phone : +90 312 394 19 90  
Fax : +90 312 394 19 94  
E-mail: info@umman.com.tr  
Web: www.umman.com.tr





\*Aggregate weighing belt is available



\*Drum coating is available.\*KR type reducer is used.\*Rope switch is used.



\*Guide roller part is available. \*SNL bearing type is used.



## MIXER POURING CHUTE



\*Since the mixer pouring chute is bolted, it provides ease of maintenance.



\*0.75 kW single stage additive pump is available.



\*3" valve with butterfly actuator is available.



\*Valve is available.



\*Dalgakiran compressor is available.

## OUR PLANT EQUIPMENT

## CABIN AND AUTOMATION



\*Dimension(mm):2000x2000x3000  
\*PVC System (Insulating Glass) Insulation, Walls polystyrene foam, ceiling glass wool



\*Siemens/ABB Switching material  
\*Omron/PLC  
\*Laptop  
\*Manual Control (Mimic)  
\*Air conditioner: Available (9000 btu)



\*Fully automatic operating system  
\*Weighing indicator very useful and easy interface  
\*Software (Cabiness)  
\*Preparation and printing of requested reports

## SETTLEMENT PLAN

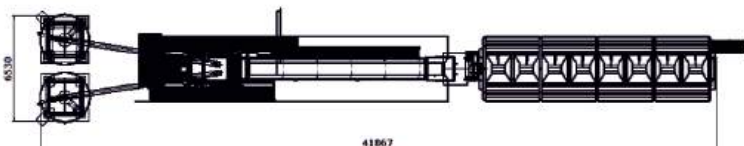
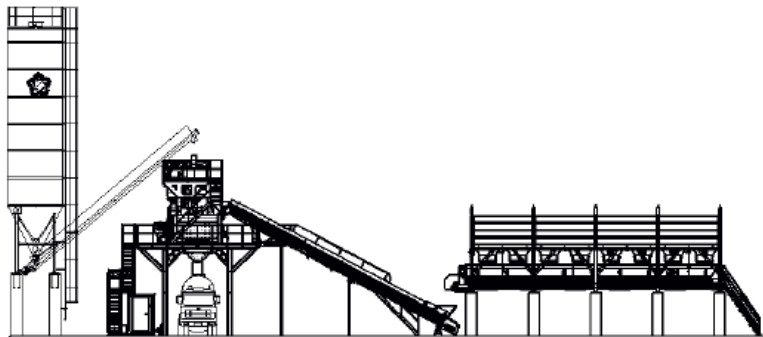

## TRANSPORT PLAN

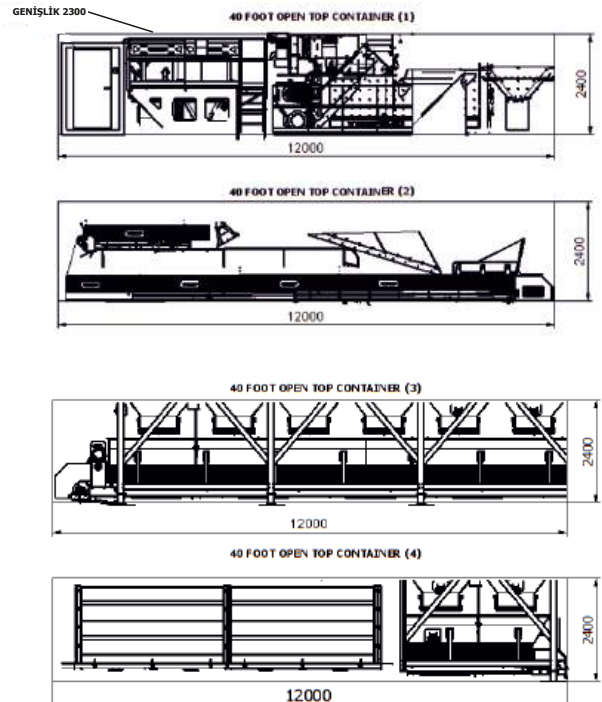

CONTACT US!

UMMAN A.S.  
Address: İvedik O.S.B 1341.Cad.  
No:71 Yenimahalle / ANKARA  
Phone : +90 312 394 19 90  
Fax: +90 312 394 19 94  
E-mail: info@umman.com.tr  
Web: www.umman.com.tr



